

Installation Instructions

ECHO Lock (3450)

Special Notes

Before installing the ECHO Lock (3450), download the ECHO mobile app and familiarise yourself with the operation and functions.
Please check template is correct scale as copies can be distorted.

Installation Guide

ECHO lock can be fitted to standard Double 'D' pierce hole. **(Picture 1)**
If an anti-twist version of lock supplied an extra 2 holes $\text{Ø}6.2$ would be required. **(Picture 2) ***

The 3450 lock is supplied with a stop plate to control lock rotation, locking nut (22mm A/F), cam washer & cam fixing screw (M4).

Step 1

Remove all packaging.

Step 2

IMPORTANT! Ensure handle is positioned as shown in **(Picture 3)** Logos at top & bottom and housing stop is positioned at bottom as shown in **(Picture 4)**.

Step 3

Holding the lock in position, fit the locking nut & tighten to 5Nm max. to secure as shown in **(Picture 4)**.

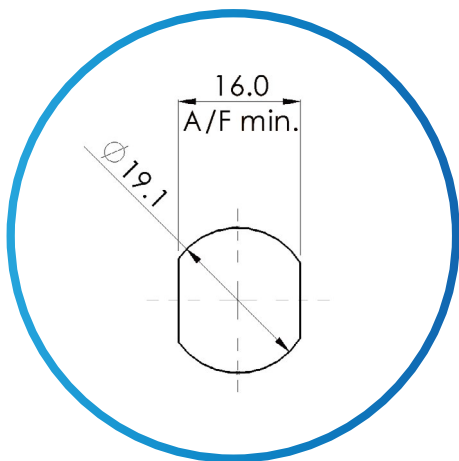

Picture 1

Standard 'D' piercing

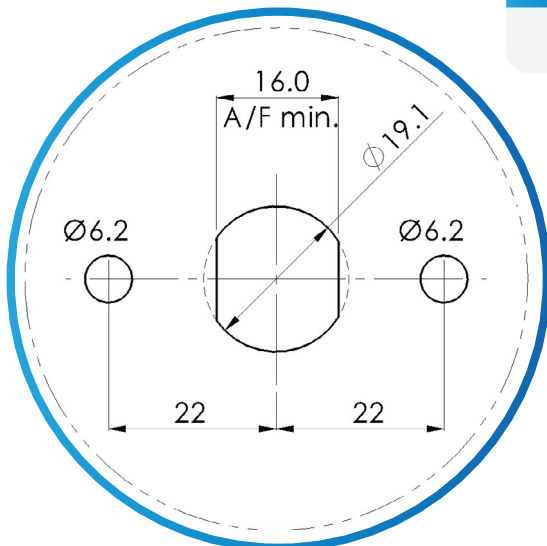

Picture 2

Twist Resist fitting

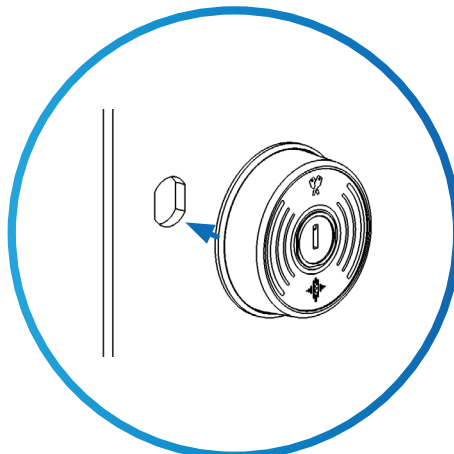

Picture 3

Position Lock through door panel as shown.

Installation Instructions

ECHO Lock (3450)

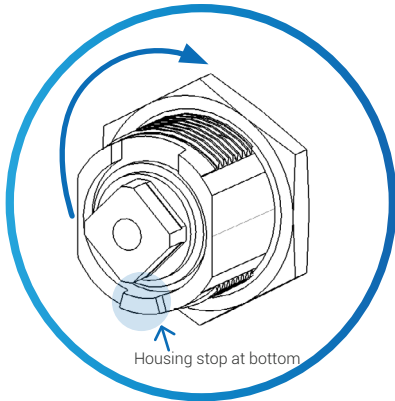

Picture 4

Fit locking nut & tighten to secure.

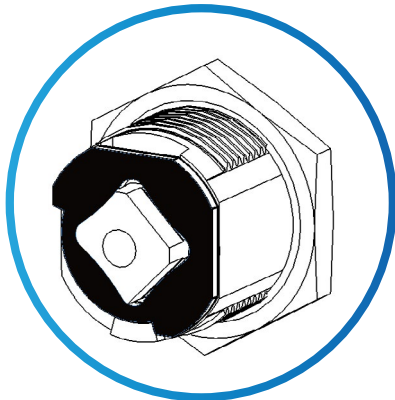

Picture 5a

Fit stop plate as shown for **RH** unlocking. CW to open.

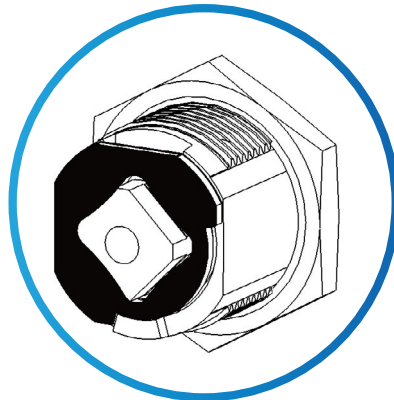

Picture 5b

Fit stop plate as shown for **LH** unlocking. CCW to open

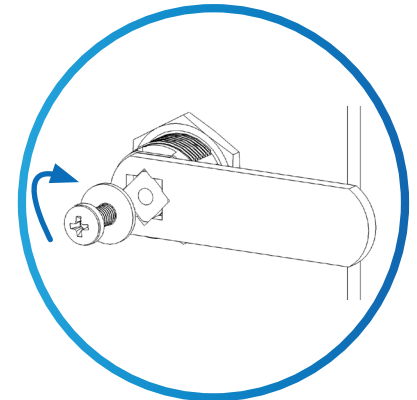

Picture 6

Fit cam, washer & Screw. Tighten with No.2 Pozidriv®

Step 4

For RH fitting (clockwise to open), fit stop plate as shown in **(Picture 5a)**.

For LH fitting (counter-clockwise to open), fit stop plate as shown in **(Picture 5b)**.

Step 5

Position the cam onto the rear of the lock as required, fit the cam washer and fixing screw as shown in **(Picture 6)**.

Step 6

Tighten the cam fixing screw using a No.2 Pozidriv® to 1.5Nm. Take care not to damage the screw thread when fitting the screw.

Step 7

Before closing the door, test the lock by rotating 90°.

Step 8

Your lock should be ready to use.

Lowe & Fletcher Ltd (UK)

E: sales@lowe-and-fletcher.co.uk
T: +44 (0) 121 505 0400

Lowe & Fletcher Inc (USA)

E: sales@loweandfletcherinc.com
T: +44 (0) 121 505 0400

Euro-Locks SA (France)

E: euro-locks@euro-locks.fr
T: +33 (0)3.87.92.61.11

Euro-Locks SA NV (Belgium)

E: sales@euro-locks.be
T: +32 61 212.261

Euro-Locks Sicherheitseinrichtungen GmbH (Germany)

E: vertrieb@euro-locks.de
T: +49 (0) 6897 9072 0

Euro-Locks Sp. z o. o. (Poland)

E: sekretariat@euro-locks.pl
T: +48 (32) 344-78-70, -82, -84